

## PL4214

NO.	DESCRIPTION	NO.	DESCRIPTION	NO.	DESCRIPTION
1	Foam pipe	24	3# triangle knob	47	Hexagon head bolts
2	Upper handle	25	Outer cover of hub	48	"O" ring
3	Brake lever	26	Self-locking nut	49	Inlet pipe
4	Lever block	27	Wheel assy.	50	Outlet pipe
5	Hex lock nut	28	Height adjustment ball	51	Board for Height Adjuster
6	Cable fix base	29	Wave washer	52	Fabric grass bag
7	Bolt	30	Rear drive assy.	53	Phillips flat head self tapping screw
8	Brake cable	31	R type pin	54	Blade washer
9	Rope Guide	32	Bolt	55	Catcher Top
10	Cap nut	33	Flat washer	56	Catcher window
11	Cable clip	34	Height Adjustment Rod	57	Catcher top protection board
12	Lower handle	35	Deck assy.	58	Catcher frame
13	Pin	36	Cable block	59	Lock washer
14	Quick knob	37	Bolt	60	Rear discharge cover
15	Quick knob lever	38	Half round head square neck bolts	61	Cover spring
16	Knob lever fix	39	Left bracket	62	Rear discharge cover shaft
17	Handle block	40	Rear discharge base	63	Wheel assy.
18	5# triangle knob	41	Large flat washer	64	Front drive assy.
19	Hexagon nut	42	Phillips flat head self tapping screw	65	Blade Adapter
20	Flat knob	43	Rear discharge cover support	66	Bar blade
21	Flat washer	44	Right bracket	67	Blade washer
22	Half round head square neck bolts	45	Petrol engine	68	Inch hex flange bolts
23	Half round head square neck bolts	46	Square Gas		

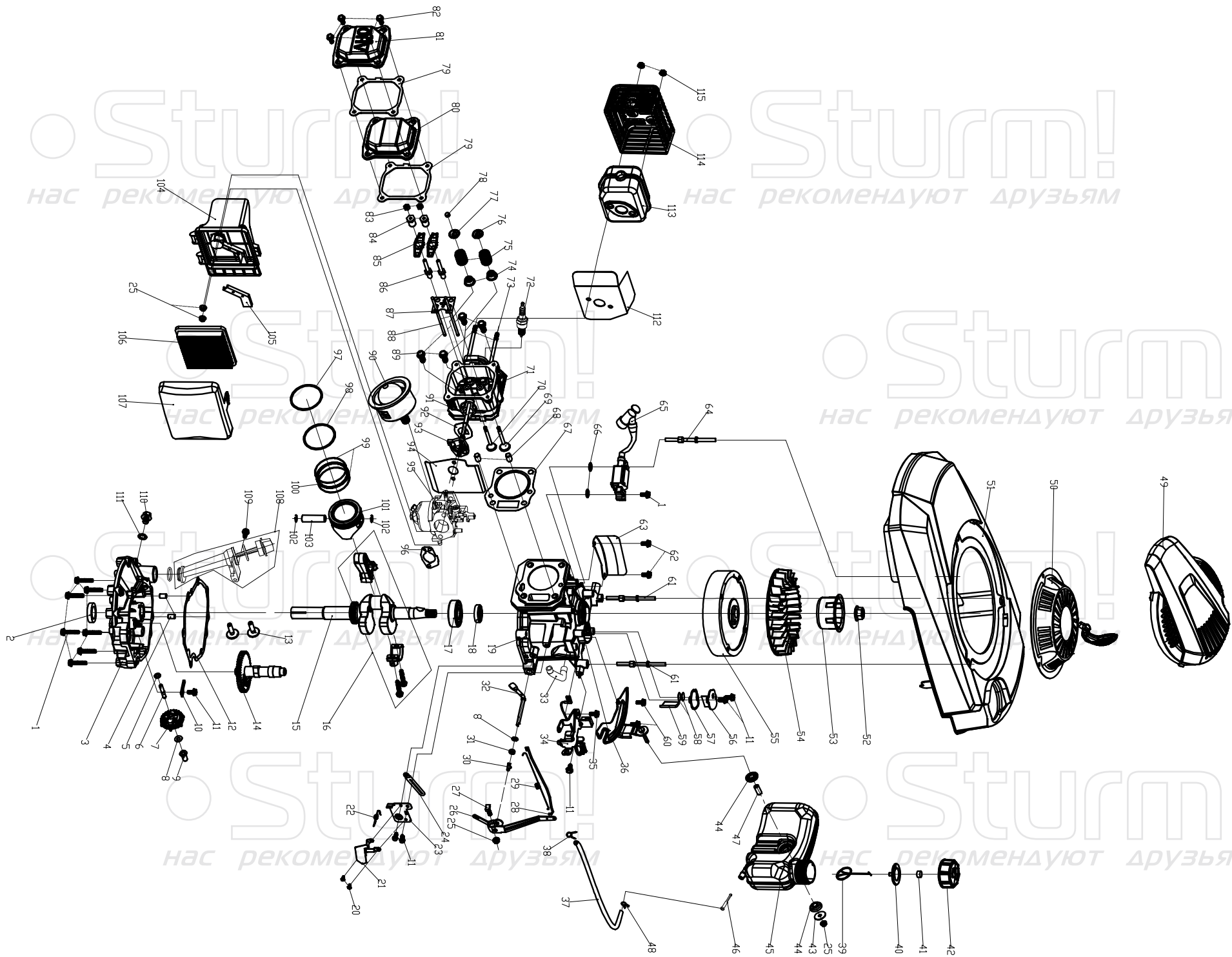

# ENGINE FOR PL4214

NO.	DESCRIPTION	NO.	DESCRIPTION	NO.	DESCRIPTION
1	Bolt	40	Fuel Tank Cap seal gasket	79	Respirator head gasket
2	Oil seal	41	fuel tank cap sponge	80	cylinder head cover I
3	crankcase cover	42	fuel tank cap	81	cylinder head cover II
4	Locating pin	43	The oil tank mount big washer	82	Bolt
5	Gasket	44	Tank damping rubber pad	83	And nuts
6	Rate-limiting gear shaft	45	fuel tank body	84	Valve adjustment nut
7	Rete-limiting gear assy.	46	Filtering Net Duct of Fuel	85	Rocker of Valve
8	Gasket	47	Fuel tank mounting bushing	86	valve rocker arm support bolts
9	Sliding Sleeve	48	fuel pipe lock clamp I	87	push rod director plate
10	rate-limiting gear shaft	49	The transparent cover	88	push rod
11	Bolt	50	pull starter assy.	89	locking bolt
12	Box combination gasket	51	The transparent cover	90	prime button II
13	pin	52	Hex flange nuts	91	Dual-head bolts
14	camshaft assy.	53	starter hub	92	Carburetor paper pad I
15	crankshaft assy.	54	fan	93	Air Inlet Pipe
16	connecting rod assy.	55	flywheel assy	94	Carburetor gasket
17	rolling bearing	56	Respirator Cover Plate Assy	95	Carburetor assy.
18	oil seal	57	Respirator head gasket	96	Carburetor paper pad II
19	Crankshaft box assy	58	Respirator valve plate	97	Piston Ring I
20	Bolt	59	oil filter net	98	Piston Ring II
21	Single-stage speed regulation guard	60	Hexagon head bolts	99	Guide Rail
22	Single-stage speed regulation control spring	61	Different-shaped double-head bolts II	100	Bushing Ring
23	Single-stage speed regulation assy.	62	Bolt	101	Piston
24	clip	63	wind shield	102	Piston Pin circlip
25	Hex flange nuts	64	Different-shaped double-head bolts I	103	piston pin
26	Speed rocker arm	65	ignition assy.	104	An air filter base.
27	bolt	66	flat Gasket	105	Vent groove cover plate
28	Throttle Valve Rod	67	Cylinder head gasket	106	Sponge filter
29	Throttle valve spring	68	spacing pin	107	Air Filter Upper Cover
30	R type pin	69	IntakeValve	108	Lubricating Gauge Assy
31	oil seal	70	Exhaust Valve	109	Bolt
32	rate-limiting rocker arm shaft	71	cylinder head assy.	110	Oil drain bolt
33	waste pipe	72	spark plug	111	Oil drain bolt gasket
34	detent assy.	73	Dual-head bolts	112	Muffler insulating pad
35	Bolt	74	oil seal assy	113	muffler assy.
36	main bracket of fuel tank	75	valve spring	114	muffler cover assy.
37	fuel pipe	76	Spring Coil of Intake Valve	115	Self-locking nut
38	fuel pipe lock clamp II	77	Spring Coil of Exhaust Valve		
39	connect cable of fuel cap	78	Top Cover of Exhaust Valve		