

Sturm!
нас рекомендуют друзья

BP8760VD

NO.	DESCRIPTION	NO.	DESCRIPTION
A1	ENGINE	A2-20	BOLT
A2	PUMP	A3	BRACKET
A2-1	NUT	4	NUT
A2-2	PUMP COVER	5	FLAT WASHER
A2-3	MECHANICAL SEAL ASSEMBLY	6	SPRING WASHER
A2-4	WASHER	7	RUBBER FOOT
A2-5	BOLT WITH FLANGE	8	BOLT
A2-6	O-RING	A9	ACCESSORIES KITS
A2-7	IMPELLER	A9-1	HOSE WRENCH (1.5")
A2-8	WORN WHEEL CASE	A9-2	HOSE JOINT (1.5")
A2-9	O-RING	A9-3	SEALING RING (1.5")
A2-10	PUMP BODY	A9-4	LID WRENCH (1.5")
A2-11	HOLDER	A9-5	CLAMP (1.5")
A2-12	WASHER	A9-6	HOSE WRENCH (2.0")
A2-13	WATER OUTLET	A9-7	HOSE JOINT (2.0")
A2-14	BOLT	A9-8	SEALING RING (2.0")
A2-15	O-RING	A9-9	LID WRENCH (2.0")
A2-16	KNOB	A9-10	CLAMP (2.0")
A2-17	BOLT WITH FLANGE	A9-11	LID (2.0")
A2-18	NOT-RETURN VALVE	A9-12	STRAINER (2.0")
A2-19	WATER INLET		

RU-ST20170929
VER:2.1

Sturm!
нас рекомендуют друзья

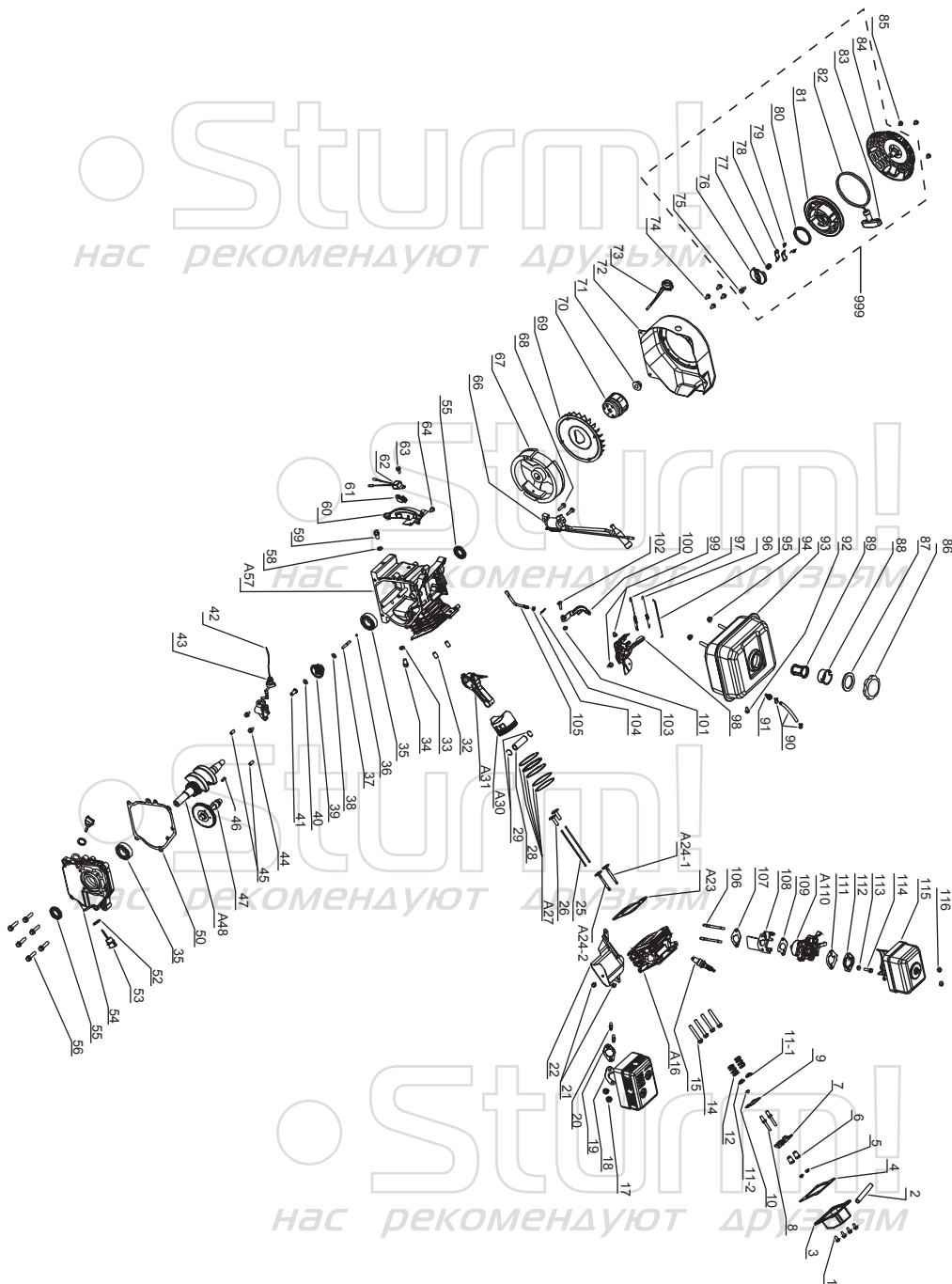

ENGINE FOR BP8760VD

NO.	DESCRIPTION	NO.	DESCRIPTION	NO.	DESCRIPTION
1	BOLT	39	GOVERNOR WEIGHT HOLDER COMP	81	RECOIL STARTER REEL
2	VENT-PIPE	40	GOVERNOR HOLDER CLIP	82	RECOIL STARTER ROPE
3	HEAD COVER COMP	41	GOVERNOR COVER	83	RECOIL STARTER KNOB
4	HEAD COVER PACKING	42	NUT	84	RECOIL STARTER COMP
5	PIVOT ADJUSTING NUT	43	OIL SENSOR ASSEMBLY	85	FLANGE BOLT M6×8
6	ROCKER ARM PIVOT	44	BOLT	86	FUEL TANK CAP
7	VALVE ROCKER ARM	45	FIXED PIN	87	SEALING RING
8	PIVOT BOLT	46	WOODRUFF KEY	88	STEEL BUSH
9	PUSH ROD GUIDE PLATE	47	CAMSHAFT ASSEMBLY	89	FILTER
10	VALVE ROTATOR	A48	CRANKSHAFT ASSEMBLY	90	FUEL TUBE
11-1	EXHAUST VALVE SPRING RETAINER	50	PAPER GASKET	91	FUEL NUZZLE
11-2	INTAKE VALVE SPRING RETAINER	52	OIL FILLER CAP PACKING	92	BOLT
12	VALVE SPRING	53	OIL FILLER CAP ASSEMBLY	93	FUEL TANK
14	FLANGE BOLT M8×55	54	CRANKCASE COVER	94	NUT
15	SPARK PLUG	55	OIL SEAL	95	GOVERNOR ROD
A16	CYLINDER HEAD COMP	56	BOLT	96	GOVERNOR SPRING
17	NUT	A57	CRANKCASE	97	THRITTLE RETURN SPRING
18	MUFFLER COMP	58	DRAIN BOLT WASHER	98	GOV.SETTING COMP.
19	WASHER	59	DRAIN PLUG BOLT	99	BOLT
20	STUD BOLT	60	FLYWHEEL GUARD	100	GOVERNOR ARM
21	BOLT	61	CLIP	101	NUT
22	WIND FENDER	62	DIODE COMP	102	BOLT
A23	CYLINDER HEAD GASKET	63	BOLT	103	LOCK PIN
A24-1	INTAKE VALVE	64	BOLT	104	WASHER
A24-2	EXHAUST VALVE	66	IGNITOR COMP	105	GOVERNOR ARM SHAFT
25	PULL ROD	67	FLYWHEEL	106	STUD BOLT
26	VALVE LIFTER	68	BOLT	107	WASHER
A27	PISTON RING ASSEMBLY	69	COOLING FAN	108	CARBURETOR INSULATOR
28	PISTON PIN	70	START HUB	109	CARBURETOR PACKING
29	PISTON PIN CLIP	71	NUT	A110	CARBURETOR ASSEMBLY
A30	PISTON	72	FAN COVER COMP	111	CARBURETOR PACKING
A31	CONNECTING ROD COMP	73	ENGINE SWITCH COMP	112	CARBURETOR WASHER
32	FIXED PIN	74	BOLT	113	NUT
33	DRAIN BOLT WASHER	75	SETTING SCREW	114	BOLT
34	DRAIN PLUG BOLT	76	RATCHET GUIDE	115	AIR CLEANER GENERAL ASSY.
35	BEARING 6205	77	RATCHET GUIDE SPRING	116	NUT
36	CIRCLIP	78	STARTER RATCHET	999	RECOIL STARTER ASSY
37	GOVERNOR SHAFT	79	RETURN SPRING		
38	GOVERNOR HOLDER CLIP	80	SPRING		

RU-ST20170929
VER:2.1